

# BUILDING PRODUCTS

## FIELD LABELING OF FIRE DOORS

FIELD EVALUATIONS TO NATIONAL STANDARDS AND LOCAL BUILDING CODES

---

Obtain the proper labeling required by code to avoid unnecessary removal and replacement of your buildings' fire doors through our field review and labeling process.

---

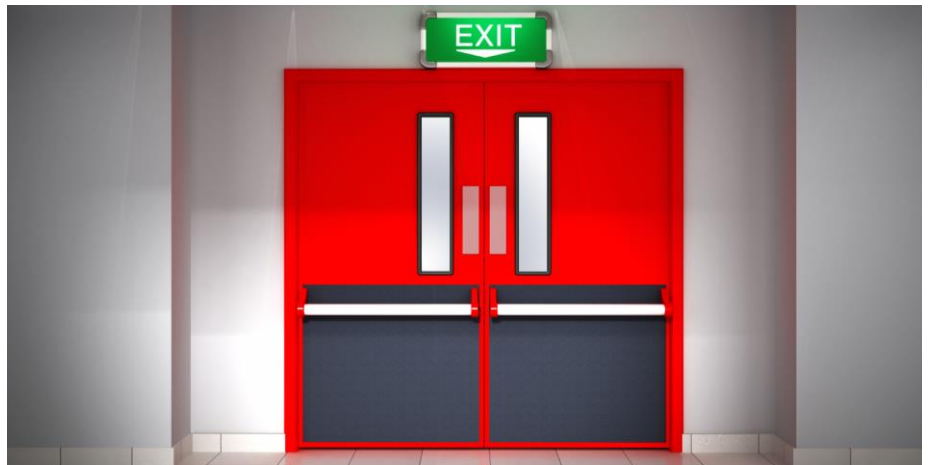

### The Need for Field Labeling

Field labeling may become necessary for a variety of reasons, such as in-field modifications, doors leaving the factory without labels, incorrect labeling, or labeling that has been painted over or removed.

When field labeling services are required, both the Authority Having Jurisdiction (AHJs) and the manufacturer need to be assured that the body conducting the field labeling service has an in depth knowledge of the doors and frames that they are labeling.

It is critical that the field inspector has access to supporting documentation for the doors and frames that they are labeling to correctly identify and address field modifications and properly relabel the opening protective.

### The Solution

Facility managers, building owners, and others responsible for a building and its occupant's safety need to work with their distributors to ensure that all of their opening protectives have been correctly labeled by an accredited third party prior to being installed, which will help to avoid the risk and liability on the back end that comes with mislabeled products.

However, when openings' products are found at the jobsite that are not correctly labeled, the certification agency has the knowledge to re-label these doors when it is appropriate.

### The Intertek Solution

If field labeling for fire doors is required, Intertek experts provide the means to identify the modification needed and provide insight into what will be required to make that modifi-

cation, such as engineering analysis or additional testing. When an Intertek engineer conducts field labeling on a fire door, they are relying on a wealth of knowledge of that door and an in-depth understanding of every aspect of fire doors. Intertek's field evaluation process provides a broad review of all openings within a building, saving time and additional expense for clients.

Working with Intertek aligns you with a partner with the history, expertise, and industry involvement to meet all of your needs for certifying and labeling your doors and frames.

Partnering with Intertek brings you a team that can certify doors in their entirety and critically apply engineering judgements based on an extensive knowledge of testing in a quick and efficient manner.

# BUILDING SCIENCES SOLUTIONS

## WHOLE BUILDING AIR TESTING

### Field Evaluation Process

**Older openings, including doors, windows, and frames, are usually not labeled, and therefore are not fire rated and most likely need to be replaced.**

To reduce this burden, Intertek's Field Labeling service includes a comprehensive review of all openings in question.

Intertek will then make recommendations for any changes required for upgrading. Once the opening has been modified as needed, Intertek's Warnock Hersey (WH-ETL) Mark is applied, indicating compliance with building and fire code requirements.

This valuable service may provide significant savings by avoiding the extensive costs involved with a complete tear-out and replacement of existing components and door assemblies.

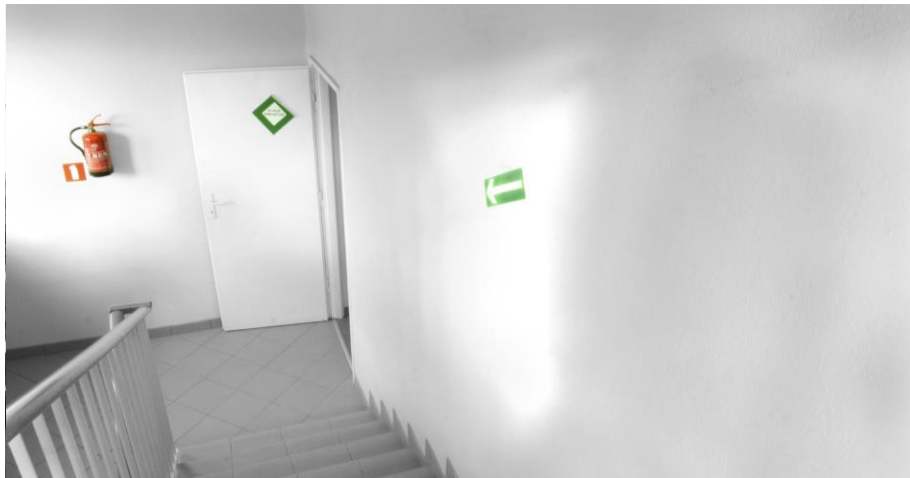

Openings can require relabeling due to paint, wear and tear, or not being labeled from the factory.

### Warnock Hersey Mark

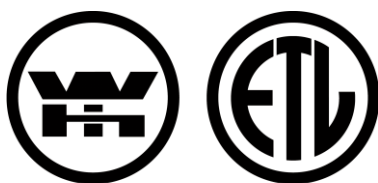

# Intertek

Intertek's Warnock Hersey Mark has long been one of the industry's most recognizable marks and is found on a variety of products including hearth, plumbing, fire doors, and windows.

As one of the industry's preferred marks for fire doors, it provides Authorities Having Jurisdiction (AHJs) the confidence they need to approve a fire door.

In 2013, Intertek introduced the next evolution of the Warnock Hersey mark. The new mark combined the ETL Mark with the traditional Warnock Hersey (WH) Mark to leverage the fire-safety strength of the WH Mark with the electrical-safety strength of the ETL Mark.

### Building Better Together

Over the last few years we have grown significantly through the acquisition of leading industry organizations. Starting in 2005, we purchased Texas-based Omega Point Laboratories (OPL) expanding our fire testing capabilities. In 2013, Architectural Testing, Inc. (ATI) joined the family expanding our reach into the building sciences market and adding to our fenestration, thermal, and acoustic capabilities. Most recently, both the MT Group and PSI became a part of Intertek in 2015. The addition of these organizations allowed Intertek to expand our services further downstream taking our services out of the lab onto the construction site.

As we have grown, we have been able to leverage the most desirable qualities of each organization while increasing our service offerings and creating a better customer experience. With each expansion of the Intertek family, our partners benefited from the synergies inherent with expanded capabilities, gained further access to global and domestic markets, and accessed a more comprehensive suite of services throughout the building and construction project life cycle.

### Built on Legacy

Intertek's Building & Construction division stands on the shoulders of giants. Our history of innovation, growth, and expanded services comes from a legacy of leading industry organizations whose spirit and culture continue to drive our desire to serve our clients ever better.



### FOR MORE INFORMATION

 1.800.WORLD.LAB

 [icenter@intertek.com](mailto:icenter@intertek.com)

 [intertek.com/building](http://intertek.com/building)